

NOTICE!!

These documents have been scanned!

Do not place un-scanned documents beneath this notice!

Do not remove this notice from this file!

GPO Jacket No. 560-102
Print Order 61540
Rise Business Services, LLC
Job=AZ15 4/26/2019



Box Number= AZ15002



Claim Begin-End: AMC449378-AMC449378

1 Initial Receipt



AZ15002-6

AMC450400-AMC453366

United States Department of the Interior
Bureau of Land Management
 DIV OF LANDS, MINRLS & ENERGY
 ONE N CENTRAL AVE
 PHOENIX, AZ 85004 -4427
 Phone: 602-417-9200

Receipt

No: 4099749

Transaction #: 4212264	
Date of Transaction: 02/28/2018	
CUSTOMER:	
TED BIGELOW PO BOX 1887 PORT ANGELES, WA 98362-0282 US	

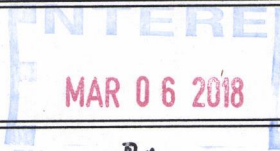
 BY: *Ran*

LINE #	QTY	DESCRIPTION	REMARKS	UNIT PRICE	TOTAL
1	1.00	LOCATABLE MINERALS / MINING CLAIMS-NEW,UNADJUD, ONE OR MORE AUTH NOS / NEW MINING CLAIM PROCESSING FEE CASES: AMC449378/\$20.00		- n/a -	20.00
2	1.00	LOCATABLE MINERALS / MINING CLAIMS-NEW,UNADJUD, ONE OR MORE AUTH NOS / NEW MINING CLAIMS LOCATION FEE CASES: AMC449378/\$37.00		- n/a -	37.00
3	1.00	LOCATABLE MINERALS / MINING CLAIMS-NEW,UNADJUD, ONE OR MORE AUTH NOS / NEW MINING CLAIMS MAINTENANCE FEE CASES: AMC449378/\$155.00		- n/a -	155.00
4	1.00	LOCATABLE MINERALS / MINING CLAIMS-NOT NEW-UNADJUD,ONE AUTH NO. ONLY / MINING CLAIM MONEY RECEIVED CASES: AMC449378/\$155.00	ADDL MAINT FEE FOR ASSOC PLACER	- n/a -	155.00
TOTAL:					\$367.00

PAYMENT INFORMATION				
NOTE: Items will appear on credit card statement as "Bureau of Land Mgmt CO".				
1	AMOUNT:	367.00	POSTMARKED:	N/A
	TYPE:	CREDIT CARD	RECEIVED:	02/28/2018
	NAME:	BIGELOW, TED PO BOX 1887		

	PORT ANGELES WA 98362-0282 US	
CARD NO:	XXXXXXXXXXXX6656	AUTH CODE: 016768
NAME ON CARD:	THEODORE S BIGELOW	
EXPIRES:	02/2018	
SIGNATURE:		

REMARKS

This receipt was generated by the automated BLM Collections and Billing System and is a paper representation of a portion of the official electronic record contained therein.

NOTICE!!

These documents have been scanned!

Do not place un-scanned documents beneath this notice!

Do not remove this notice from this file!

GPO Jacket No. 560-102
Print Order 61540
Rise Business Services, LLC
Job=AZ15 4/26/2019



Box Number= AZ15002



Claim Begin-End: AMC449378-AMC449378

2 Correspondence



AZ15002-6 AMC450400-AMC453366

**NO
DOCUMENTS
FOUND**

NO DOCUMENTS FOUND
NO DOCUMENTS FOUND

NOTICE!!

These documents have been scanned!

Do not place un-scanned documents beneath this notice!

Do not remove this notice from this file!

GPO Jacket No. 560-102
Print Order 61540
Rise Business Services, LLC
Job=AZ15 4/26/2019



Box Number= AZ15002



Claim Begin-End: AMC449378-AMC449378

3 Transfers



AZ15002-6

AMC450400-AMC453366

**NO
DOCUMENTS
FOUND**

NO DOCUMENTS FOUND
NO DOCUMENTS FOUND

NOTICE!!

These documents have been scanned!

Do not place un-scanned documents beneath this notice!

Do not remove this notice from this file!

GPO Jacket No. 560-102
Print Order 61540
Rise Business Services, LLC
Job=AZ15 4/26/2019



Box Number= AZ15002



Claim Begin-End: AMC449378-AMC449378

4 Annual Filings



AZ15002-6 AMC450400-AMC453366

DEPARTMENT OF THE INTERIOR
BUREAU OF LAND MANAGEMENT
MINING CLAIMS

Run Date/Time: 9/11/2018

MC Maintenance Fees Paid Through the BLM Pay Portal
(by Date Paid)

Page 404 Of 723

CBS Receipt: 4248173

Printed For Lead File # **AMC449378**

Agency Tracking ID: 1535498159

Assessment Year: 2019

Paid On: 8/29/2018

Number of BLM Serial Nr: 5

Total Amount Paid: \$1,705.00

Claim Name	BLM Serial No	Lead File No	Amount Paid
JUBILATION #1	AMC401293	AMC401292	\$465.00
THOMPSONS RESERVE #2	AMC436768	AMC436768	\$310.00
GOLDEN GOOSE #2	AMC437110	AMC437110	\$310.00
HIDDEN SPRINGS NO 1	AMC440068	AMC440068	\$310.00
RATTLESNAKE LIL 2	AMC449378	AMC449378	\$310.00

United States Department of the Interior
Bureau of Land Management
 BUSINESS & SUPPORT SVCS DIV
 ONE N CENTRAL AVE SUITE 800
 PHOENIX, AZ 85004 -4427
 Phone: 602-417-9200

Receipt

No: 4248173

Transaction #: 4363647	
Date of Transaction: 08/28/2018	
CUSTOMER:	
SHEILA R BIGELOW 220 DOGWOOD PL PORT ANGELES, WA 98362 US	

LINE #	QTY	DESCRIPTION	REMARKS	UNIT PRICE	TOTAL
1	1.00	LOCATABLE MINERALS / MINING CLAIMS- NOT NEW-UNADJUD, ONE AUTH NO. ONLY / MINING CLAIM MONEY RECEIVED CASES: AMC401293/\$1705.00		- n/a -	1705.00
TOTAL:					\$1,705.00

PAYMENT INFORMATION			
NOTE: Items will appear on credit card statement as "BLM O Mining Claim".			
1	AMOUNT:	1705.00	POSTMARKED: N/A
	TYPE:	CREDIT CARD	RECEIVED: 08/28/2018
	NAME:	SHEILA R BIGELOW 220 DOGWOOD PL PORT ANGELES WA 98362 US	
	CARD NO:	XXXXXXXXXXXX1214	AUTH CODE: 022231
	NAME ON CARD:	SHEILA R BIGELOW	
	SIGNATURE:		

REMARKS

This receipt was generated by the automated BLM Collections and Billing System and is a paper representation of a portion of the official electronic record contained therein.

NOTICE!!

These documents have been scanned!

Do not place un-scanned documents beneath this notice!

Do not remove this notice from this file!

GPO Jacket No. 560-102
Print Order 61540
Rise Business Services, LLC
Job=AZ15 4/26/2019



Box Number= AZ15002



Claim Begin-End: AMC449378-AMC449378

5 Miscellaneous



AZ15002-6 AMC450400-AMC453366

**NO
DOCUMENTS
FOUND**

NO DOCUMENTS FOUND
NO DOCUMENTS FOUND

NOTICE!!

These documents have been scanned!

Do not place un-scanned documents beneath this notice!

Do not remove this notice from this file!

GPO Jacket No. 560-102
Print Order 61540
Rise Business Services, LLC
Job=AZ15 4/26/2019



Box Number= AZ15002



Claim Begin-End: AMC449378-AMC449378

6 Location Notices-Amendments and Supporting Documents



AZ15002-6 AMC450400-AMC453366

MINING CLAIM STATUS REPORT

Data Entered: 3/6/18 RAM

MTP Checked By: EC
GEO Checked By: EC

LEAD SERIAL NUMBER: AMC 449378 thru AMC _____

NUMBER OF CLAIMS & TYPE:

LODE

PLACER
1
ASSOCIATION PLACER

MILL SITE

TUNNEL SITE

CHARGES:

Processing Fee @ \$20 = \$ 20
Location Fee @ \$37 = \$ 37
Maintenance Fee @ \$155 = \$ 155
Add'l Maint Fee for Assoc Placer = \$ 155
SUBTOTAL \$ 367

Other Fees \$ _____

Other Fees \$ _____
TOTAL \$ _____

TOTAL ACREAGE: 40 Per Claim
(Placer Only)

NUMBER OF LOCATORS: 2

DOCUMENTS RECEIVED VIA: Over-the-Counter Mail **TIMELY FILED:** Yes No

LEGAL DESCRIPTION: T 6N R 3W SEC 5
T _____ R _____ SEC _____
T _____ R _____ SEC _____
T _____ R _____ SEC _____
T _____ R _____ SEC _____

BLM FOREST SERVICE _____ SUBJ TO PL 359: Yes No
WILDERNESS AREA _____

SPLIT ESTATE: N/A SX PX OTHER _____
SRHA Was proper Notice filed if located on SHRA Land? Yes No

RECONVEYED MINERALS ON BLM LAND REQUIRE OPENING ORDER FROM 1944 TO 1993:
Open to Entry On _____ N/A

COMMENTS/STATUS: VOID PARTIALLY VOID PVT MINERALS WITHDRAWN LANDS
OTHER _____

[] Claimant acknowledges that portions of the following claim(s) site(s) may be void or voidable.

Printed Name of Claimant _____ Signature of Claimant _____

*****FINAL ADJUDICATION*****

DATE 3/9/18 INITIALS EDS

AMC 449378

**DEPARTMENT OF THE INTERIOR
BUREAU OF LAND MANAGEMENT
MINING CLAIMS**

(LIVE) Serial Register Page

Run Date/Time: 03/06/2018 10:26 AM

Page 1 of 1

01 10-21-1976;090STAT0090;43USC1744
Case Type 384201: PLACER CLAIM
Claim Name: RATTLESNAKE LIL 2
Commodity :
Case Disposition: ACTIVE
Required Maintenance Fee: \$310.00

Total Acres
40.000

Serial Number
AMC449378
Lead File Number
AMC449378

Name & Address				Int Rel		
BIGELOW TED	PO BOX 1887	PORT ANGELES, WA 98362-0282		CLAIMANT		
BIGELOW SHEILA	PO BOX 1887	PORT ANGELES, WA 98362-0282		CLAIMANT		
Mer Twp	Rng	Sec	Quadrant	District/Field Office	County	
14	0060N	0030W	005	NE	HASSAYAMPA FO	MARICOPA

Act Date	Code	Action	Action Remarks	Receipt Number
12/10/2017	403	LOCATION DATE		
02/28/2018	395	RECORDATION NOTICE RECD	1	4099749
02/28/2018	484	LOCATION YEAR / MAINTENANCE	2018;\$155	4099749
02/28/2018	392	MONIES RECEIVED	\$155.00;1	4099749
02/28/2018	501	ACCT ADV IN LEAD FILE	AMC449378;	
02/28/2018	685	ADDL MAINTENANCE FEE	2018;\$155	4099749

Line Nr Remarks

LOCATION NOTICE FOR PLACER MINING CLAIM

NOTICE IS HEREBY GIVEN that the Rattlesnake Lil #2 placer mining claim has been located by Ted & Sheila Bigelow P.O. BOX 1987
Port Angeles, Wa, 98363

The general course of this claim is square and it is situated in Maricopa County(ies), Arizona.

This claim is 1320 feet in length and 1320 feet in width. This claim runs from the location monument on which the location notice is posted approximately 1320 feet in a S direction to the S end line and 1320 feet in a W direction to the W end line. This claim is marked by four monuments, one at each corner of the claim.

The location monument on which this notice is posted is situated within Section 5, Township 6 N, Range 3 W, Gila Salt River Base and Meridian, Arizona. This claim encompasses portions of the following legal subdivision(s) if located by legal subdivision or the following quarter section(s), Section(s), Township(s), and Range(s): NE 1/4 NE 1/4 Sec. 5
T6N R3W, Gila Salt River Base and Meridian, Arizona.

The locality of this claim with reference to some natural object or permanent monument and additional information (if any) concerning its locality are as follows: That 40 acres of
which the NEC is located at the NEC of
USGS Sec. 5, T6N R3W.

DATED AND POSTED on the ground this 10th day of Dec., 2017.

LOCATOR(s) 1 Bigelow
Sheila Bigelow

BLM DATE STAMP:

PHOENIX, ARIZONA
2018 FEB 28 P 2 02
RECEIVED
MAR 1 2018

AMC449378

BLM DATE STAMP:

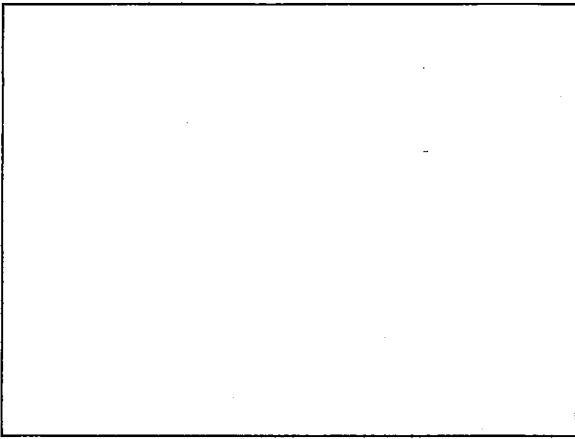

CLAIM MAP

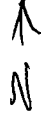

Lode () Placer (X)

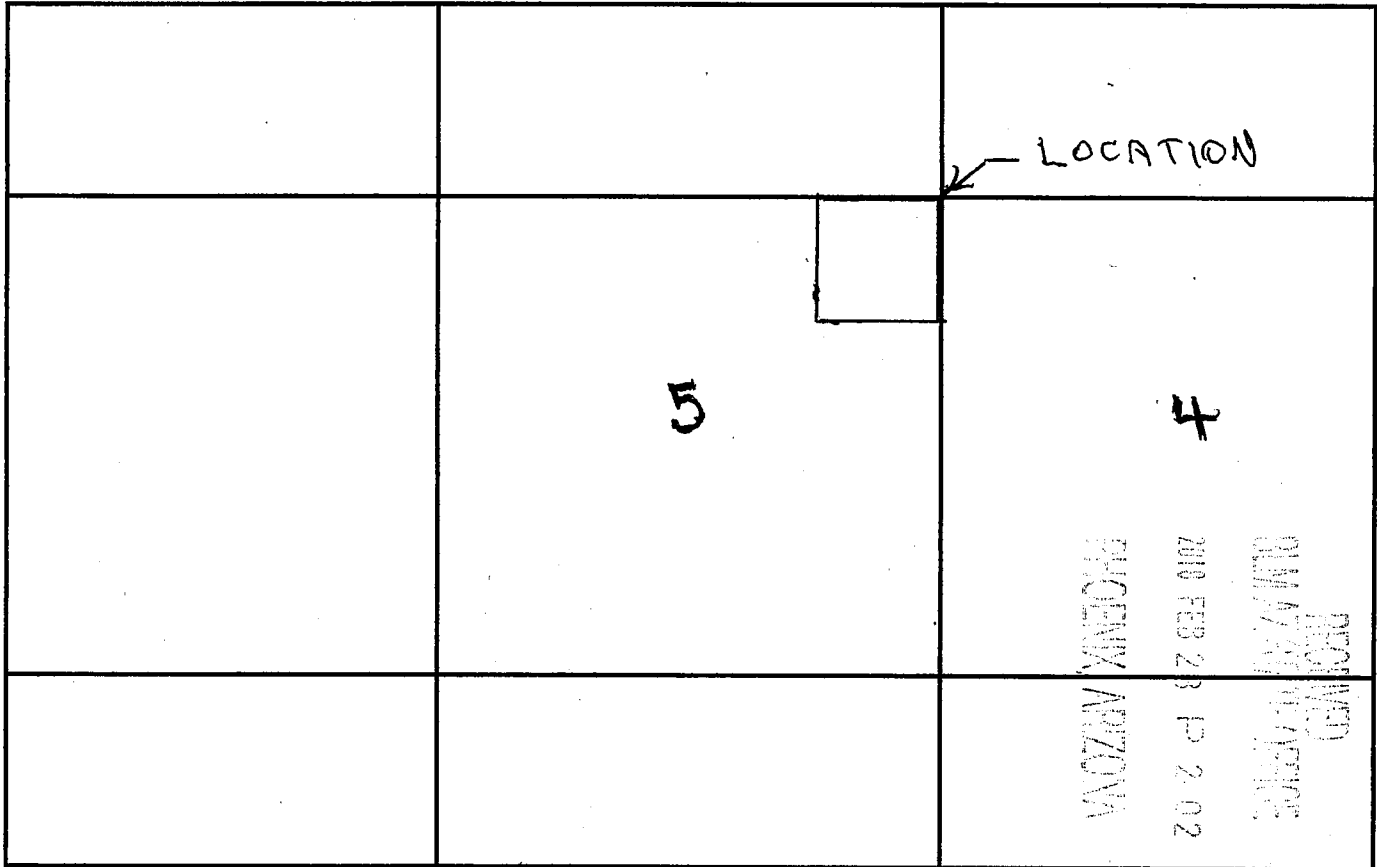

Scale: 1" = _____

1. The above map depicts the Rattle Snake Hill #2 mining claim, which is located in the NE 1/4 NE 1/4 of Section(s) 5, Township 6 N, Range 3 W, Gila and Salt River Base and Meridian, Maricopa County Arizona.

2. The type of corner and location monuments used are as follows: 2" x 4" capped PVC on steel stakes.

3. The bearings and distances in degrees and feet between claim corners are as depicted on the map.

NOTE: DRAWING NOT TO SCALE

DEPARTMENT OF INTERIOR
BUREAU OF LAND MANAGEMENT

Input Parameters for Geographic Report with Land

System Id = CR

Admin State = AZ

Geo State =

Casetype Begins With

Case Disp Txt = AUTHORIZED, CANCELLED, EXPIRED, PENDING, REJECTED, RELINQUISHED, VOID, WITHDRAWN

Mer Twp Rng =

Section =

Mtrs = 14 0060N 0030W 005, 14 0060N 0030W 999

Commodity =

Commodity Txt =

Pending Org =

Pend Org Decode =

Total Rows Returned: 0

